

Rittal spare parts

LCP Rack DX, 12kW, 300x2000x1200

Model No. 3311.420

Download

(high definition)

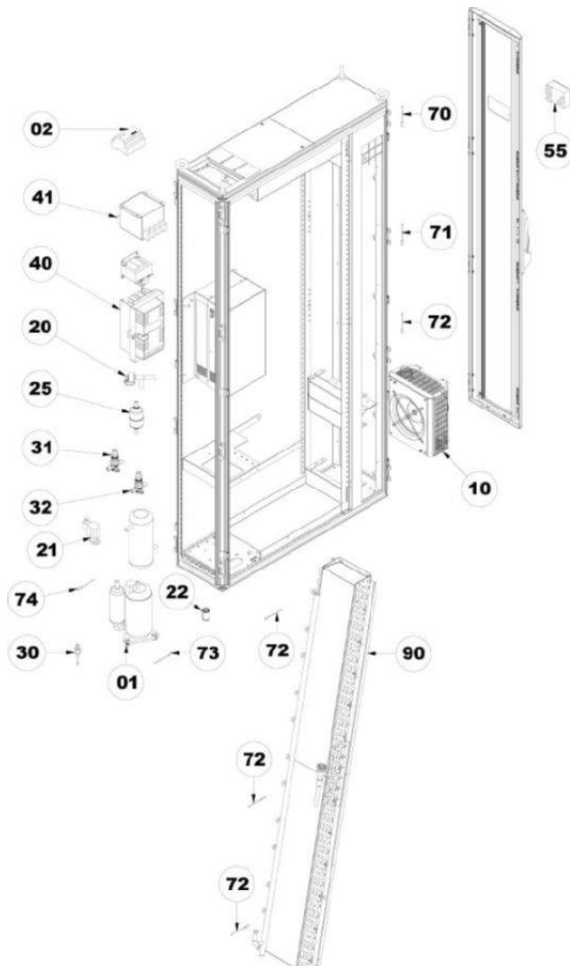

01	SK Compressor	---- 3398.187
02	SK Speed control	---- 3398.191
10	SK Radial fan	---- 3398.183
20	SK Expansion valve	---- 3398.181
21	SK Valve	---- 3397.927

22	SK Non-return valve	3398.180	----
25	SK Filter dryer	3398.122	----
30	SK Pressostat	3398.123	----
31	SK Pressure transmitter	3398.188	----
32	SK Pressure transmitter	3398.186	----
40	SK Controller	3398.189	----
41	SK Power pack	3397.832	----
45	SK Snmp-board f. LCP Rack/Inline/Room DX	3398.097	----
55	SK Display	3398.094	----
70	SK Temperature sensor	3396.209	----
71	SK Temperature sensor	3396.614	----
72	SK Temperature sensor	3397.682	----
73	SK Temperature sensor	3398.184	----
74	SK Temperature sensor	3398.185	----
90	SK Evaporator coil	3398.182	----

« **choose another product** »